

South Similkameen Branch #192 – Keremeos

COVID-19 – Re-Opening Requirements for Members & Guests

- Main entrance is ENTER ONLY. Follow all instructions - they are for everyone's safety.
- Use sanitizer prior to entering Canteen.
- Be courteous to the bartenders and volunteers. They are following WorkSafe COVID-19 Regulations.
- Sign In – PRINT your name and phone number so we can contact you if we need to let you know there has been a confirmed case of COVID at the Legion.
- Place your order at the bar – one person at a time – maintain social distancing as indicated by floor markings.
- Tables have been spread to a distance of 6'. Do not re-arrange tables. There is one table for seating of 6 for a "family" group and all other tables will seat 2 "family" members. Our maximum seating during COVID-19 is 42.
- There are hand sanitizers at the main door, ATM/Lotto dispensers as well as beside the exit ramp.
- Please maintain social distancing when using the washroom facilities. If there is only room for 1 – 2 in the bathroom at a time – please wait outside the doorway. Wash your hands before exiting.
- All tables will be disinfected after each member/guest leaves. We will be making every effort to regularly disinfect all areas where surface touching is needed (hand railings, door handles, ATM, Lotto terminal, washrooms, table surfaces, chairs, etc).
- EXIT is via the handicap ramp by the Ladies Washroom.
- We are asking for an extra volunteer on duty at this time to assist the volunteer bartender so everyone is participating appropriately and safely.
- As we move forward, we will be changing things to accommodate further requirements. We ask for your continued patience and Thank-You for supporting our Legion.
- We will be re-opening with reduced days & hours of operation. **Starting Friday, May 29 from 2 – 6 PM with Bunny Races at 4:30 PM; Saturday May 30 from 2 – 6 PM with a mini "restart" Meat Draw at 3 PM.** At this time we will only be open Friday & Saturdays but working towards other days and activities.



ENTRANCE
NO EXIT

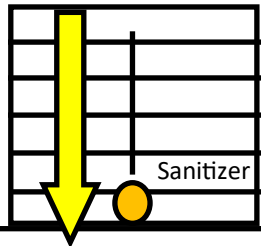

Maximum Seating Capacity during COVID-19

- 42 -

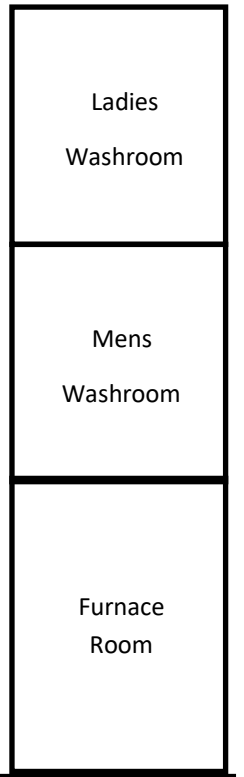
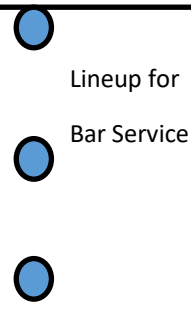
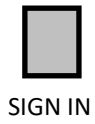
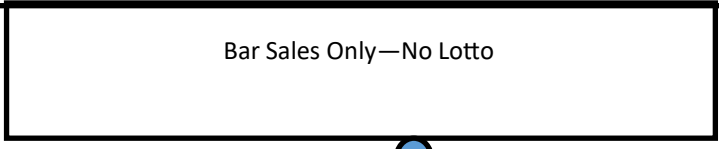
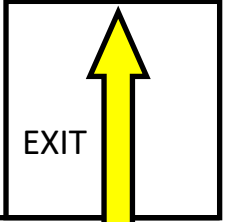

ATM

Self Serve Lotto



Sanitizer

Darts & Pool Table area CLOSED